

DILATOFLEX® M



AR / CN
Red label

Inner lining grades

YP
Yellow label

GZ
Orange label

AB
Grey label

EPC
Cream label

TE
Mauve label

HH
Blue label

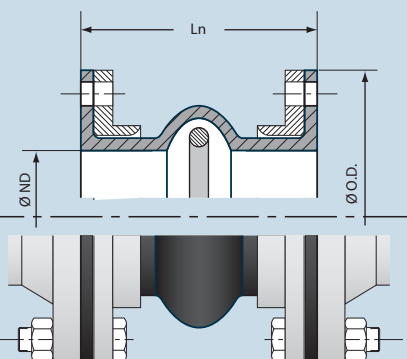
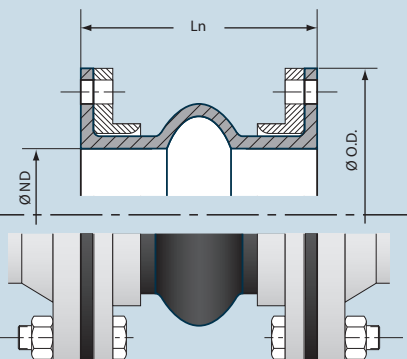
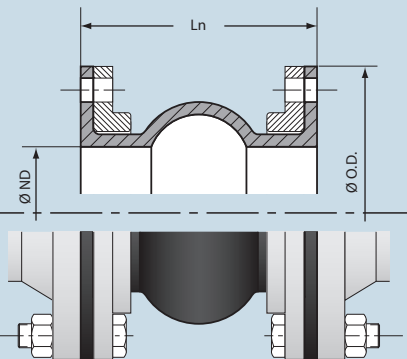
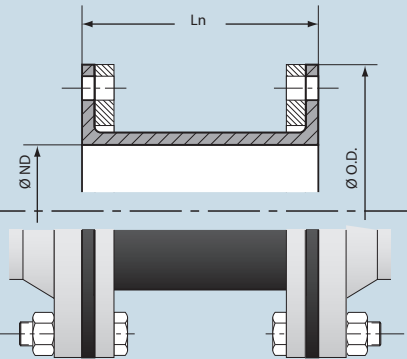

Example of Label

DILATOFLEX® MD

DIMENSIONAL DATA					TECHNICAL DATA									
Nominal Diameter	Nominal length (Ln in mm)	Drilling standards			Max. permissible pressure (bar) (1)	Max permissible vacuum (% vacuum)	Max. Permissible Movements (maximum values do not apply simultaneously)						End thrust in daN for P= 1 bar	Approx. weight in kg (with steel flanges) (2)
		ISO 2084	NF EN 1759-1	NF EN 1092-1			Axial		Lateral	Angular				
ND	NPS	Other lengths: please consult us.		Other drillings: please consult us.			Compression	Elongation	Shearing	angle α° degree				
mm	inch						Ln - Lc mm	Le - Ln mm	R mm	P	V			
Type MD 40														
500	20	225	250	X	4	100%	20	0	30	2.3	1.7	2.3	42	
600	24	225	250	X	4	100%	20	0	30	1.9	1.4	3.2	53	
800	32		250	X	4	100%	20	0	30	1.4	1.1	5.6	82	
1000	40		250	300	4	100%	20	0	30	1.1	0.9	8.5	111	
1200	48		300	X	4	100%	20	0	30	0.9	0.7	12.1	179	
1400	56		300	X	4	100%	20	0	30	0.8	0.6	16.4	225	
1600	64		300	X	4	100%	25	0	30	0.9	0.5	21.2	345	
1800	72		300	X	4	100%	25	0	30	0.8	0.5	26.7	392	
2000	80		300	X	4	100%	25	0	30	0.7	0.4	32.9	450	
2200	88		300	X	4	100%	25	0	30	0.7	0.4	39.6	525	
For any intermediate sizes and further sizes up to ND 2800mm (112"), please consult us.														
Type MS 50														
500	20		250	X	6	0%	20	15	30	4.0	-	2.4	49	
600	24		250	X	6	0%	20	15	30	3.3	-	3.4	60	
800	32		250	X	6	0%	20	15	30	2.5	-	5.8	92	
1000	40		250	300	6	0%	20	15	30	2.0	-	8.8	122	
1200	48		300	X	6	0%	20	15	30	1.7	-	12.4	200	
1400	56		300	X	6	0%	20	15	30	1.4	-	16.4	251	
1600	64		300	X	6	0%	20	15	30	1.2	-	21.5	391	
1800	72		300	X	6	0%	20	15	30	1.1	-	27.0	438	
2000	80		300	X	6	0%	20	15	30	1.0	-	33.1	500	
2200	88		300	X	6	0%	20	15	30	0.9	-	39.9	580	
For any intermediate sizes and further sizes up to ND 2800mm (112"), please consult us.														
Type MA 60														
500	20		250	300	X	10	0%	30	30	30	6.8	-	2.6	54
600	24		250	300	X	10	0%	30	30	30	5.7	-	3.6	68
800	32		250	300	X	10	0%	30	30	30	4.3	-	6.1	98
1000	40		250	300	X	10	0%	30	30	30	3.4	-	9.1	135
1200	48		300	X	10	0%	30	30	30	2.9	-	12.8	215	
1400	56		300	X	10	0%	30	30	30	2.4	-	17.2	273	
1600	64		300	X	10	0%	30	30	30	2.1	-	22.1	405	
1800	72		300	X	10	0%	30	30	30	1.9	-	27.7	454	
2000	80		300	X	10	0%	30	30	30	1.7	-	33.9	514	
2200	88		300	X	10	0%	30	30	30	1.6	-	40.7	617	
For any intermediate sizes and further sizes up to ND 2800mm (112"), please consult us.														
Type MB 60														
500	20		250	300	X	8	100%	30	10	30	4.6	4.6	2.6	61
600	24		250	300	X	8	100%	30	10	30	3.8	3.8	3.6	77
800	32		250	300	X	8	100%	30	10	30	2.9	2.9	6.1	109
1000	40		250	300	X	8	100%	30	10	30	2.3	2.3	9.1	149
1200	48		300	X	8	100%	30	10	30	1.9	1.9	12.8	232	
1400	56		300	X	8	100%	30	10	30	1.6	1.6	17.2	290	
1600	64		300	X	8	100%	30	10	30	1.4	1.4	22.1	426	
1800	72		300	X	8	100%	30	10	30	1.3	1.3	27.7	477	
2000	80		300	X	8	100%	30	10	30	1.1	1.1	33.9	550	
2200	88		300	X	8	100%	30	10	30	1.0	1.0	40.7	645	
For any intermediate sizes and further sizes up to ND 2800mm (112"), please consult us.														

(1) Limited to the nominal pressure of the drilling standard being used
 (2) Steel retaining flanges in 1 part (zinc-chromated, hot-dip galvanized or stainless steel)